

# BELKIN®

## Residential Gateway (RG) Battery Backup REV B



### **Save this user manual**

This manual contains important instructions regarding the installation and operation of this device. Read this manual thoroughly before attempting to install or operate this device.

# Table of Contents

---

	Page
<b>Introduction</b> .....	3
Safety Information.....	3
System Requirements.....	3
Package Contents .....	4
Recycling .....	4
<b>Controls and Status Indicators</b> .....	5
<b>Audible and Visual Alarms</b> .....	6
<b>Installation</b> .....	7
<b>Operation</b> .....	8
<b>Battery Replacement Procedure</b> .....	9
<b>Warranty</b> .....	10
<b>Technical Specifications</b> .....	11

# Introduction

---

This Residential Gateway (RG) Battery Backup, once properly installed and used, has been designed to maintain your AT&T U-verse® Voice service in the event of a short disruption to your commercial power service.

## Safety Information

### CAUTION

- Internal battery voltage is 12V DC.
- Incorrect battery connection or replacement creates risk of explosion.
- The RG Battery Backup is intended for installation and operation in a controlled environment (temperature controlled, indoor area free of conductive contaminants).
- No user-serviceable parts exist inside the unit. Refer repair issues only to qualified personnel. Fuses or other parts must be replaced **ONLY** with parts of identical types and ratings. Substitution of non-identical parts can cause fire and other safety hazards.
- All batteries used are sealed lead batteries. Batteries should be recycled.
- The RG Battery Backup shall be installed near an easily accessible power outlet.

## System Requirements

The RG Battery Backup is designed for use with the AT&T U-verse Residential Gateway and your AT&T U-verse Voice service.

**NOTE: Your AT&T U-verse Voice service, including 911 dialing, will not function without electrical or battery-backup power. The RG Battery Backup supplies power for your AT&T U-verse Voice service; it does not supply power for cordless phones (and it does not supply power for your network interface device or optical network terminal, typically located on the outside of your home, which may also require battery-backup power for your AT&T U-verse Voice service to function).**

Therefore, in the event of a power outage, you should ensure you have one corded single-line, touchtone phone connected directly to the AT&T U-verse Residential Gateway or your in-home wiring and the AT&T U-verse Residential Gateway connected to the RG Battery Backup. (Rotary/pulse phones do not work with AT&T U-verse Voice service.) If you connect more than one corded phone, it will use more power; if you connect a cordless phone, it will not function without a separate battery backup, and not all cordless phones are so equipped. If you have a monitored home alarm, you should never plug a multi-line phone directly into the Residential Gateway—it could interfere with the alarm signals. You should not connect the RG Battery Backup to any device other than the AT&T U-verse Residential Gateway or use it with any service other than your AT&T U-verse Voice service, and you should always have an alternative means of dialing 911, such as via a cellular telephone.

# Introduction

---

## Package Contents

You should have received the following:

- 1 – RG Battery Backup unit (12V sealed lead-acid battery included inside unit )



## Recycling

UNIT CONTAINS SEALED LEAD-ACID BATTERY. UNIT SHOULD BE RECYCLED. Belkin International, Inc., advocates sound environmental management of used batteries.



**For battery replacement and recycling information, please call us at 866-539-5791, or visit our website at [www.belkin.com/gatewaybattery](http://www.belkin.com/gatewaybattery).**

# Controls and Status Indicators

---

Shown below are the controls and indicator lights on the RG Battery Backup.

## 1 Power on/off

Power on/off switch is located on the back panel. Use this switch to turn the RG Battery Backup on/off. The unit will not supply power to the AT&T U-verse Residential Gateway when power switch is in OFF position.

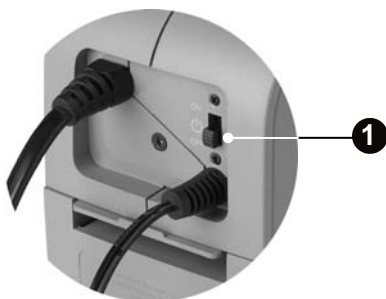

## 2 Status Indicators

Three LED status lights are located on the front panel. The status lights indicate specific conditions of the device. (See page 6.)



## 3 Mute on/off

Use this switch to turn the mute function on/off. The audible alarms will be silenced when mute switch is in ON (down) position.

### **Federal Communication Commission Interference Statement Subpart B**

This equipment has been tested and found to comply with the limits for a Class B digital device, pursuant to Part 15 of the FCC Rules. These limits are designed to provide reasonable protection against harmful interference in a residential installation. This equipment generates uses and can radiate radio frequency energy and, if not installed and used in accordance with the instructions, may cause harmful interference to radio communications. However, there is no guarantee that interference will not occur in a particular installation. If this equipment does cause harmful interference to radio or television reception, which can be determined by turning the equipment off and on, the user is encouraged to try to correct the interference by one of the following measures:

- Reorient or relocate the receiving antenna.
- Increase the separation between the equipment and receiver.
- Connect the equipment into an outlet on a circuit different from that to which the receiver is connected.
- Consult the dealer or an experienced radio/TV technician for help.

This device complies with Part 15 of the FCC Rules. Operation is subject to the following two conditions: (1) This device may not cause harmful interference, and (2) this device must accept any interference received, including interference that may cause undesired operation.

FCC Caution: Any changes or modifications not expressly approved by the party responsible for compliance could void the user's authority to operate this equipment.

**BELKIN®**

[www.belkin.com](http://www.belkin.com)

### **Belkin Tech Support**

US: 866-539-5791

[www.belkin.com/gatewaybattery](http://www.belkin.com/gatewaybattery)

### **Belkin International, Inc.**

501 West Walnut Street







Los Angeles, CA 90220, USA

310-898-1100

310-898-1111 fax

## Audible and Visual Alarms

The RG Battery Backup alarms to indicate certain events.

Front-Panel Label	Visual Indicator	Audible Alarm	Description
On A/C	Green LED lights 	None	The RG Battery Backup is operating on A/C.
Testing Battery	Green LED flashes 	None	The RG Battery Backup is conducting a self-test. This procedure is normal and will occur when the self-test is manually initiated and periodically thereafter (see page 8). This procedure will last approximately 5 minutes.
On Battery	Yellow LED lights 	Tone every 10 seconds	The RG Battery Backup is operating on battery power. The alarm will stop when the A/C power is restored.
Low Battery	Yellow LED flashes 	Tone every 1 second	The battery energy is running low. This alarm will continue until the unit performs a forced shutdown when the battery is depleted or A/C power is restored.
Replace Battery	Red LED flashes 	Tone every 5 seconds	The battery may have reached the end of its useful life. Conduct a self test (see page 8). If the alarm remains on, replace the battery as soon as possible to ensure proper operation of the RG Battery Backup (see page 9).
Fault	Red LED lights 	Continuous tone	A fault has occurred. Reset the RG Battery Backup (the unit) by: <ul style="list-style-type: none"> <li>* Turn off the unit</li> <li>* Disconnect unit from the AC outlet</li> <li>* Reconnect unit to the AC outlet</li> <li>* Turn on the unit</li> </ul> If the fault is not corrected, turn off the unit and disconnect from the AC outlet prior to checking Residential Gateway. If fault persists, contact Belkin for assistance.

**NOTE:** Audible alarm will not sound when mute switch is in ON (down) position.

# Installation

---

**NOTE:** Before installation, please inspect the RG Battery Backup. Make sure that nothing inside the package is damaged. The RG Battery Backup must be installed near the Residential Gateway and be easily accessible.



## **STEP 1:**

### **Connect to AC Utility Power**

Make sure that the power switch on the RG Battery Backup is in the OFF position. Plug the A/C cord on the RG Battery Backup directly into a wall outlet. Do not connect the RG Battery Backup into a power strip or surge protector.



## **STEP 2:**

### **Connect to the Residential Gateway**

Connect the DC plug on the RG Battery Backup into the Residential Gateway.



## **STEP 3:**

### **Turning on the RG Battery Backup**

Turn the switch on the RG Battery Backup to the ON position. The "On A/C" LED light should illuminate.

**NOTE:** It takes approximately 18 hours to charge a new and fully depleted battery at normal indoor temperature. If a power outage occurs before the battery is fully charged, the battery-backup time shown on page 11 will be reduced. Therefore, you should not rely on battery-backup power for at least 18 hours after your RG Battery Backup is initially installed or a replacement battery is thereafter installed. During these periods especially, and at all other times in general, you should ensure that you have an alternative means of dialing 911, such as via a cellular telephone. Your AT&T U-verse Voice service, including 911 dialing, will not function without electrical or battery-backup power.



# Operation

---

- **Turning off the RG Battery Backup**  
Turn switch to OFF position. The “On A/C” LED light should turn off.
- **To Silence Audible Alarm**  
Turn mute switch to ON (down) position.
- **To Conduct a Self-Test**  
Use the self-test to verify both the operation of the RG Battery Backup and the condition of the battery. Turn the mute switch ON and OFF (down and up), then ON and OFF (down and up) again within five seconds.

The RG Battery Backup automatically conducts a self-test every 21 days.

**NOTE: During the self-test, the RG Battery Backup briefly operates on battery-backup power. The “Testing Battery” LED will flash for five minutes during the test period. If the RG Battery Backup passes the self-test, it returns to normal operation on A/C, and the green “On A/C” LED light is lit.**

If the green “Testing Battery” LED does not flash when the self-test is conducted, it is likely that the battery voltage is low. This could happen immediately following installation, during the recharging period following a power failure, or during “On Battery” mode. This is normal. Wait until the battery fully recharges (18 hours) before re-initiating the self-test.

If the RG Battery Backup fails the self-test, it immediately returns to normal operation on A/C and lights the “Replace Battery” LED. The operation of the RG is not affected. Fully recharge the battery (18 hours) and perform the self-test again. If the “Replace Battery” LED is still on, the battery needs to be replaced.

# Battery Replacement Procedure

---

To order a replacement battery or for recycling information call: 866-539-5791 or visit: [www.belkin.com/gatewaybattery](http://www.belkin.com/gatewaybattery)

The RG Battery Backup is designed with an easy-access battery door. Replacement of the battery requires removing the battery door on the rear of the device.

**No tools are needed.**



## STEP 1:

**Turn off power switch. Disconnect the RG Battery Backup from power and any connected devices.**

Remove the battery door on the rear of the RG Battery Backup by pressing the tab on the top of the battery door and pulling outward.



## STEP 2:

Remove the battery from enclosure; remove the wire connections from the battery.



## STEP 3

Connect the new battery (black-to-black, red-to-red); place the battery into enclosure.

**WARNING:** Carefully connect the wires to the correct terminals. The replacement battery will have color-coded terminals (red = +, black = -).

Do not misconnect the wires.



## STEP 4:

Securely reconnect battery door.

# Warranty

---

## **LIMITED THREE (3) YEAR WARRANTY**

### What this warranty covers.

Belkin International, Inc. warrants to the original AT&T U-Verse subscriber of this Belkin Residential Gateway (RG) Battery Backup Unit (BBU), that the RG BBU shall be free of defects in design, assembly, material, or workmanship.

### What the period of coverage is.

Belkin International, Inc. warrants the Belkin RG BBU for three (3) years from the original date of installation.

### What will we do to correct problems?

RG BBU Warranty. Belkin will repair or replace, at its option, any defective RG BBU free of charge (except for shipping charges for the RG BBU).

### What is not covered by this warranty?

All above warranties are null and void if the Belkin RG BBU is not provided to Belkin International, Inc. for inspection upon Belkin's request at the sole expense of the purchaser, or if Belkin International, Inc. determines that the Belkin RG BBU has been improperly installed, altered in any way or tampered with. The Belkin RG BBU Warranty does not protect against acts of God (including but not limited to flood and earthquake), war, vandalism, theft, normal-use wear and tear, erosion, depletion, obsolescence, abuse, or alteration.

### How to get service.

To get service for your Belkin RG BBU you must take the following steps:

1. Contact Belkin International, Inc. at 501 W. Walnut St., Compton CA 90220, Attn: Customer Service, or call (866)-539-5791 Be prepared to provide the following information: (a). The part number of the Belkin RG BBU. (b). When the RG BBU was first installed. (c). Proof of AT&T U-Verse service installation.
2. Your Belkin Customer Service Representative will then instruct you on how to forward your receipt and Belkin RG BBU and how to proceed with your claim.

Belkin International, Inc. reserves the right to review the damaged Belkin RG BBU. All costs of shipping the Belkin RG BBU to Belkin International, Inc. for inspection shall be borne solely by the purchaser. If Belkin determines, in its sole discretion, that it is impractical to ship the damaged equipment to Belkin International, Inc., Belkin may designate, in its sole discretion, an equipment repair facility to inspect and estimate the cost to repair such equipment. The cost, if any, of shipping the equipment to and from such repair facility and of such estimate shall be borne solely by the purchaser. Damaged products must remain available for inspection until the claim is finalized. Whenever claims are settled, Belkin International, Inc. reserves the right to be subrogated under any existing insurance policies the purchaser may have.

### How state law relates to the warranty.

THIS WARRANTY CONTAINS THE SOLE WARRANTY OF BELKIN INTERNATIONAL, INC., THERE ARE NO OTHER WARRANTIES, EXPRESSED OR, EXCEPT AS REQUIRED BY LAW, IMPLIED, INCLUDING THE IMPLIED WARRANTY OR CONDITION OF QUALITY, MERCHANTABILITY OR FITNESS FOR A PARTICULAR PURPOSE, AND SUCH IMPLIED WARRANTIES, IF ANY, ARE LIMITED IN DURATION TO THE TERM OF THIS WARRANTY. Some states do not allow limitations on how long an implied warranty lasts, so the above limitations may not apply to you.

# Technical Specifications

---

## Technical Specifications:

Input Voltage Range	0 to 140VAC
Input Frequency	50/60Hz
Nominal Output Voltage	12VDC
Max Power	36W
Alarms	Visual and Audible
Operating Temperature	32 to 113 degrees F (0 to 45 degrees C)

## Battery (@ 77 degrees F, 25 degrees C):

Type/Rating	12V/7.2Ah sealed lead-acid battery
Replacement Battery Part Number	F6c127xBAT
Typical Battery Recharge Time	18 hours for a new and fully depleted battery at normal indoor temperature
Typical Backup Time	4 hours—With a new and fully charged CSB- or YUASA-branded battery or other battery recommended or supplied by Belkin, with one corded single-line, touchtone phone connected to the AT&T U-verse Residential Gateway directly or through your in-home wiring, and with no other equipment and no service other than AT&T U-verse Voice service drawing power from the RG Battery Backup. Actual results will vary, depending, among other things, on battery age, usage patterns, and environmental conditions.

# BELKIN®

## Residential Gateway (RG) Battery Backup-REV B

### Caution:

- Only install in a safe area that is free of obstructions that block the Unit's air vents and excessive dust.
- Screws must be appropriate for the total weight of the unit and the mounting surface material.

### Wall-Mount Instructions

#### Required Tools and Materials:

- Drill Bit – Size is determined by the anchors or screw. Refer to the directions that came with your fasteners.
- 2 Anchors – Use appropriate type for your mounting surface. Anchors are required unless both screws are drilled directly into wood studs.
- 2 Screws – Use appropriate type for your anchor. Recommended size is #10, 2 ½" long.
- Drill and Screwdriver
- Level

#### Instructions:

1. Position this template on the wall where you want to mount the RG Battery Backup and use the level line to make sure the unit is parallel to the floor.
2. Mark the wall in the two screw locations indicated on this template. Remove the template from the wall.
3. Use a drill to drill holes where you made the mark on the wall. If you drill into a wall stud, proceed to step 5. Otherwise, continue on to step 4.
4. Insert anchor into the hole(s).
5. Screw in the screw, leaving a ¼" of the screw threads protruding from the wall.
6. Mount the RG Battery Backup on the screw.
7. Verify that the unit is securely attached to the wall.

### **Belkin Tech Support**

US: 866-539-5791

[www.belkin.com/gatewaybattery](http://www.belkin.com/gatewaybattery)

Level Line

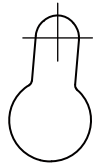

← Dashed arrow pointing to the left bulb. **Drill Hole in These 2 Locations** → Dashed arrow pointing to the right bulb.

