

**APC**<sup>®</sup>  
Legendary Reliability™

**APC AV**<sup>™</sup>

# Installation

## In-Wall Kit

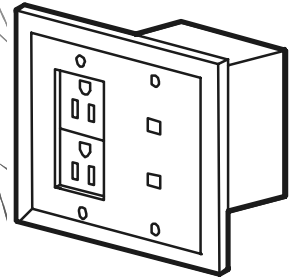

# APC AV® In-Wall Power Filter and Connection Kit

## Safety



**Electrical Hazard:** This product must be installed by a licensed electrician in accordance with the National Electrical Code.  
Use only Listed outlet boxes, per National Electric Code.

## Inventory

### Included

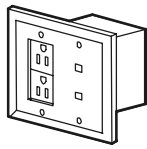

Outlet  
(1)



Inlet  
(1)

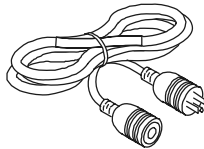

Inlet power cord  
(1)



Wirenuts  
(6)



Screws  
(6)

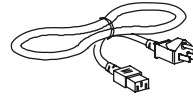

Outlet power cord  
(1)

### Required (not included)

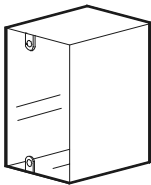

One-gang outlet box  
(1)

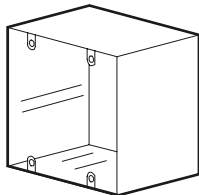

Two-gang outlet box  
(1)

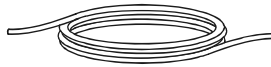

Building electrical wire

## Recommended configuration

- 1 Wall-mounted TV
- 2 Outlet faceplate
- 3 Wiring
- 4 Inlet faceplate
- 5 Power protection equipment

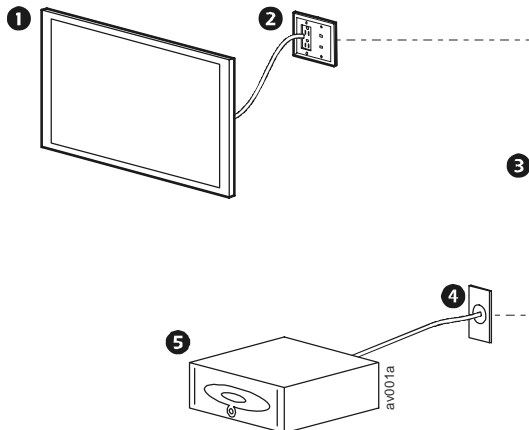

# Installation

## Install the outlet box and outlet faceplate

1. Install a two-gang outlet box (not included) in the the wall where the equipment is to be located. For a wall-mounted television, install the outlet box in the wall behind the television.
2. Run the building wire through the rear opening of the outlet box. To ensure connection to the outlet faceplate, leave at least three inches of wire extending through the outlet box.
3. Connect the building wires to the outlet faceplate. First connect the green ground building wire to the faceplate. Next, connect the neutral white wire, then the black wire. Secure the connections with the included wire nuts.
4. Secure the outlet faceplate to the outlet box using the screws provided.

## Install the outlet box and inlet faceplate

1. Install a one-gang outlet box in the wall near the rack containing the power protection equipment.
2. Connect the jumpers to the inlet faceplate using the wire nuts (included).
3. Repeat steps 2-4 above to install the inlet faceplate.

## Apply power to the unit

1. Connect the twist-lock end of the power cord to the inlet faceplate. Twist the plug to ensure a secure connection.
2. Connect the other end of the power cord to the back of the power protection equipment.
3. If the In Wall Kit is installed correctly, the WIRING OK and the FILTERING LEDs on the outlet faceplate will illuminate.

LED	Description
WIRING OK	If illuminated, the In Wall Kit is properly installed and wired properly. If not illuminated, there is a wiring problem, either: there is a missing ground connection, an overloaded neutral connection, or there is reversed polarity.
FILTERING	When illuminated, the EMI/RFI noise reduction circuitry is active. If not illuminated, the noise reduction circuitry is not active. Contact APC AV Customer Support.

# Specifications

AC Circuit	Outlets	2
	Line Voltage	120 V, 50/60 Hz
	Total Current Capacity	15 A
AC Power Cord	Length	10 ft
	Connectors	NEMA 5-15/NEMA ML-2
Inlet Faceplate	ETLus per UL514D	
	AC Connector	NEMA ML-2P
Outlet Faceplate	ETLus per UL1283 and UL514D	
	AC Connector	2 NEMA 5-15
	Noise Filtration	20 dB, NM (1-10 MHz)

Customer support and warranty information is available at the APC Web site, [www.apc.com](http://www.apc.com).

APC AV support is available at the APC AV Web site, [www.apcav.com](http://www.apcav.com).

© 2008 American Power Conversion. All rights reserved. All APC trademarks are property of American Power Conversion. Other trademarks are property of their respective owners.

**990-3365**  
**10/2008**