

AXIS SERIES CABINET CC084EPB1SBSV3 W/CAGE-NUT RAILS

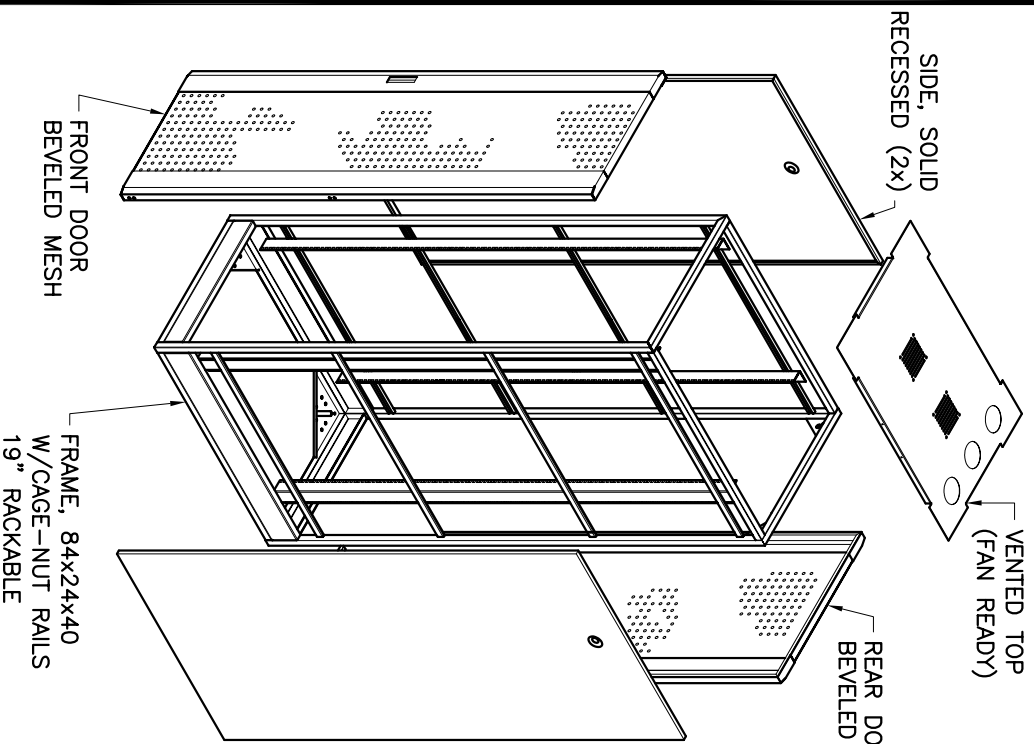

FRONT VIEW

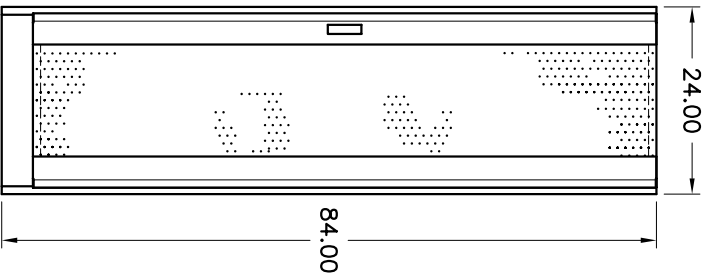

SIDE VIEW

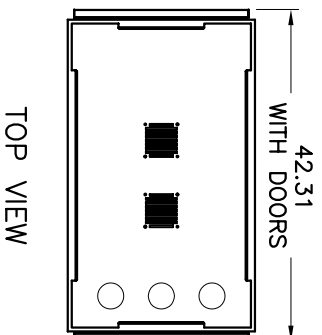
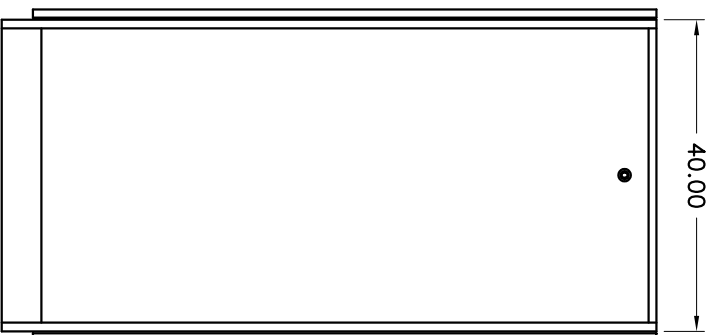

DIMENSIONS

FRAME AXIS
1x1 TUBING (16GA)
HEIGHT 84.00"
WIDTH 24.00"
DEPTH 40.00"

RAIL TYPE

L-TYPE RAILS
CAGE-NUT, M6 SCREWS
19" RACKABLE

DOORS

FRONT DOOR
MESH, BEVELED
HEIGHT 80.00"
WIDTH 22.38"
DEPTH 1.15"

REAR DOOR
MESH, BEVELED
HEIGHT 80.00"
WIDTH 22.38"
DEPTH 1.15"

SIDES

SOLID, RECESSED
HEIGHT 77.85"
WIDTH 37.85"
DEPTH 0.50"

TOP

VENTED, FLUSH
(FAN READY)
W/CABLE ACCESS
ON REAR

REVISIONS			DESCRIPTION
REV	ECO	DATE	RELEASED TO PRODUCTION
--	--	--	

DAMAC PRODUCTS INC. 14 LINDA, CA 90024		THE INFORMATION AND PROVISIONS ARE THE PROPERTY OF DAMAC PRODUCTS INC. ANY REUSE OR REPRODUCTION WITHOUT WRITTEN AGREEMENT BY DAMAC PRODUCTS INC. IS STRICTLY PROHIBITED. ©2006 DAMAC PRODUCTS INC.	
CABINET, AXIS		PART NO. CC084EPB1SBSV3	
84.00 x 24.00 x 40.00		DRAWN BY: DATE: 03/13/2006	
		CHECKED BY: CR	
		SCALE: N/A	
		MATERIAL: N/A	
		FINISH: POWDER-COATED BLACK	
		MAX BEND R=1.000 RELIEF=.060 A/R.	
		UNLESS OTHERWISE SPECIFIED	