



# TransImp<sup>®</sup>

HARD DRIVE DOCK **PLUS**

SATA TO USB 3.0

User's Manual / 使用手冊



[www.mukii.com.tw](http://www.mukii.com.tw)

## PACKAGE INCLUDES

 Please check your packing list to be sure all parts are received.

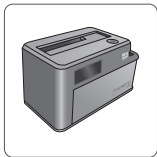

TransImp  
Hard Drive Dock Plus X 1

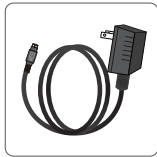

AC Power Adapter X 1

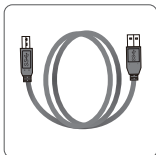

USB 3.0 Cable X 1



User's Manual x 1



Value Added  
Software CD X 1

## **TABLE OF CONTENTS**

1.FEATURE / SPECIFICATIONS .....	2
2.SYSTEM REQUIREMENTS.....	3
3.PARTS LAYOUT.....	4
4.INSTALL A HARD DRIVE TO DOCK.....	5
5.REMOVE A HARD DRIVE FROM DOCK.....	6
6.M1 TUNING SYSTEM INTRODUCTION .....	7
7.WARRANTY / CONTACT.....	8

## **目錄**

1. 產品特色 / 產品規格 .....	10
2. 系統需求 .....	11
3. 裝置說明 .....	12
4. 安裝硬碟 .....	13
5. 移除硬碟 .....	14
6. M1硬碟調校程式介紹.....	15
7. 授權 / 保證書.....	16

## 1. FEATURE / SPECIFICATIONS

### SATA to USB 3.0 HARD DRIVE DOCK PLUS :



- Easy Installation with Tool-free Design.
- Simple to Use Design; No Need to Add Enclosure or Open Case.
- Considerate Take-in Storage Bucket Design Keep Your Desk Neat & Tidy Any Time.
- USB Interface for Easy Data Access.
- Our Unique LCD Display Shows the Transmission Speed, keeping You Informed of the Transmission Status.
- Compatible with Any 2.5"/3.5" SATA Hard Drive / SATA SSD.
- Compliant with USB 3.0 Backward Compatible with USB 2.0. Transfer Rates Up to 5Gb/s with USB 3.0.
- White Paint with Aluminum Hair-line Surface Treatment Plate in Sleek Design. (TIP-D185U3-WH)
- Black Soft Touch Paint with Aluminum Hair-line Surface Treatment Plate in Sleek Design.(TIP-D185U3-BK)
- Hot Swappable : Plug and play.
- M One Tuning System Included : Auto Format / Smart Energy Saving / USB Turbo / Auto Backup / Status Feedback.

## SPECIFICATIONS

### SATA to USB 3.0 HARD DRIVE DOCK PLUS :

- Model : TIP-D185U3
- Device support : SATA I/II HDD or SATA SSD
- Device size : 2.5" / 3.5"
- Internal interface : Serial ATA
- External interface : USB 3.0
- Material : Aluminum / Plastic
- Dimension : 152.7 x 91 x 85.5 mm
- Power : AC Power Adapter

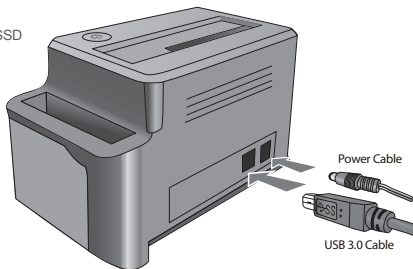

\* For the most current storage capacity & operating system support, please check our website : [www.mukii.com.tw](http://www.mukii.com.tw)

## 2. SYSTEM REQUIREMENTS



Intel Pentium II 350 MHz-compatible.  
Microsoft Windows XP/VISTA/7(32/64bit).

1. USB Equipped System
2. For USB 2.0 Speeds, the System must Support USB 2.0 Specifications
3. For USB 3.0 Speeds, the System must Support USB 3.0 Specifications
4. CD Rom Drive (for value added software)
  - ※ USB 3.0 Only Support Windows XP and above.



Mac G3 Processor .  
Mac OS X v10.4 & and above.

1. USB Equipped System
2. For USB 2.0 Speeds, the System must Support USB 2.0 Specifications
3. For USB 3.0 Speeds, the System must Support USB 3.0 Specifications
4. CD Rom Drive (for value added software)
  - ※ In order to run USB 3.0 features, Mac motherboards and external PCI-E cards must have USB 3.0 specifications.

### 3. PARTS LAYOUT

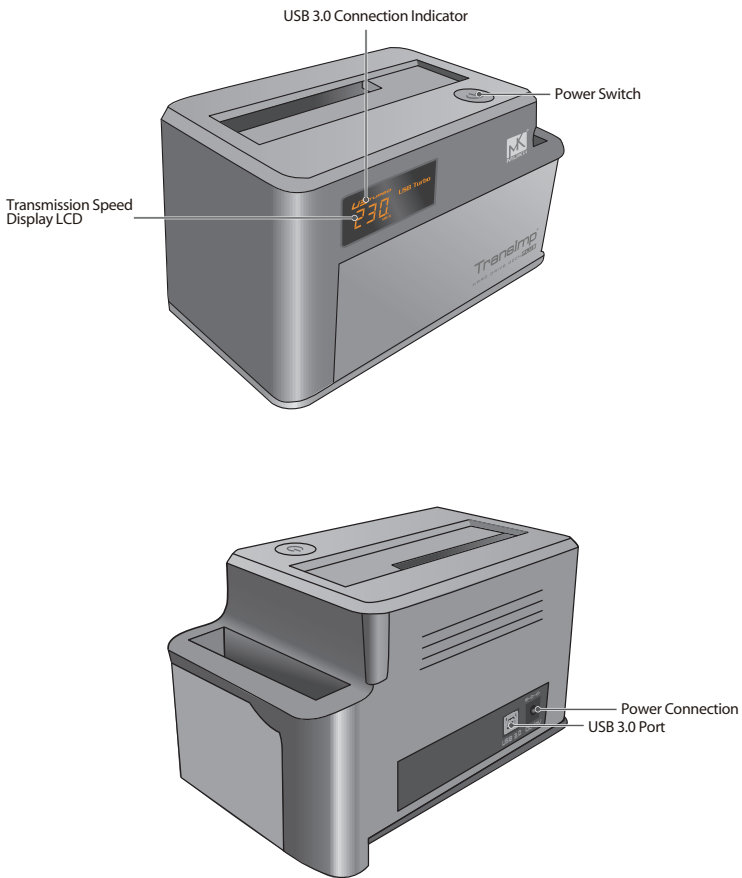

#### 4. INSTALL A HARD DRIVE TO DOCK

1. Connect the power adapter to the TransImp Hard Drive Dock.
2. Connect the USB 3.0 Cable to the TransImp Hard Drive Dock and attach the other end to your computer. (Pic-A)

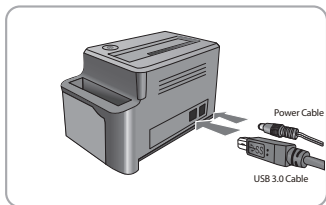

(Pic-A)

3. Insert 2.5" or 3.5" SATA HDD / SATA SSD into the slot. (Pic-B)

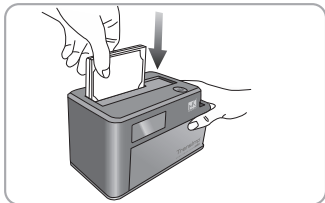

(Pic-B)

4. To turn it on, press & hold the power button until you hear a click sound, and the LCD light comes on. (Pic-C)

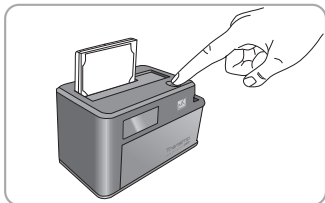

(Pic-C)

**[Note] : The new hard drive needs to be formatted and partitioned before it can be found on Widows/Mac's Desktop.**

## 5. REMOVE A HARD DRIVE FROM DOCK

**[Warning]:** Please power off the unit before removing the hard drive!

1. Remove the HDD safely from your computer system. 

2. Power off the device. (Pic-A)

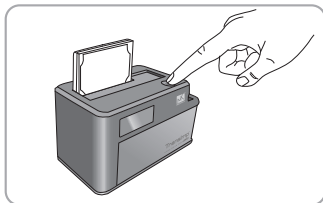

(Pic-A)

3. Stabilize the device to eject the HDD. (Pic-B)

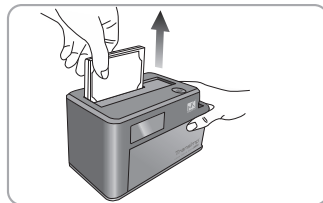

(Pic-B)



## 6. M1 TUNING SYSTEM INSTALLATION

### **Auto Format :**

Partition and format your hard drive into one or two disks, label your disk and setting partition size as you want. ( Pic-A )

( Pic-A )

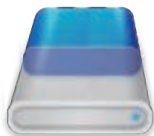

### **Auto Backup :**

Auto Backup automatically backup your critical data from local disk to MUKii TransImp external hard disk. ( Pic-B )

( Pic-B )



### **Status Feedback :**

When you connect MUKii TransImp external hard disk, you can read the status of your hard disk situation such as, the brand of HDD, available disk space, healthy condition. ( Pic-C )

( Pic-C )



### **Smart Energy Saving :**

The unit will be automatically running into sleeping mode when you stop operating it for a while.( Pic-D )

( Pic-D )



### **USB Turbo :**

Boost TransImp external hard disk data transfer rate.( Pic-E )

( Pic-E )



※ Please Find Software CD for “ M1 TUNING SYSTEM ” User’s Manual.

## 7. WARRANTY / CONTACT

The TransImp comes with a One (1) year Limited Warranty (90-day on defective parts). Should your product become defective within the specified time frame, please visit [www.mukii.com.tw](http://www.mukii.com.tw) to receive instructions for obtaining repair or warranty exchange. Cosmetic defects and missing parts are not covered by this warranty. Please check to make sure all parts are included & no visible flaws. If a replacement is required for any cosmetic defects or missing parts, please contact the retailer from whom you purchased the Product immediately.

## CONTACT



### **MUKii Technology INC.**

2F, No. 588, Tanmei St, Neihu District, Taipei City 114, Taiwan (R.O.C)

TEL : 02-87927289 FAX : 02-87920373

[www.mukii.com.tw](http://www.mukii.com.tw)